

# ECHODECO® WOODGRAIN TILES

Price Effective - January 1, 2024



## STRONG AND SILENT

Enhance the ambiance of your space while effectively managing noise. Acoustic EchoDeco® Woodgrain Tiles bring a touch of sophistication, providing both style and sound balancing benefits. From various shapes and sizes to solid colors and captivating woodgrain patterns, our Acoustic EchoDeco® Woodgrain Tiles offer you the perfect opportunity to find that ideal look you've been searching for.

- Tiles are sold in sets, quantities vary with size
- Tiles thickness — 3/8" (9mm) with NRC rating of 0.85
- Available in 5 Woodgrain patterns
- Available in 26 solid colors
- Hanging options: removable adhesive system or permanently mounted using standard construction adhesive (sold separately)
- Made in the USA
- Custom sizes and shapes available

### How to build your SKU:

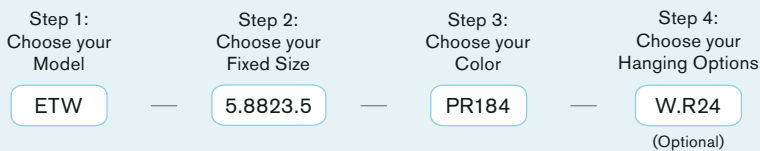

## ECHODECO® WOODGRAIN TILES

Model	Fixed Size & Set Qty	Color	Hanging Options (Optional)
ETW EchoDeco® Woodgrain Tiles (Sold in Sets)	<a href="#">Plank 23.5"w x 5.88"h - Set of 8 Tiles</a> <a href="#">Plank 5.88"w x 23.5"h - Set of 8 Tiles</a> <a href="#">Plank 23.5"w x 11.75"h - Set of 8 Tiles</a> <a href="#">Plank 11.75"w x 23.5"h - Set of 8 Tiles</a> <a href="#">Square 23.5"w x 23.5"h - Set of 8 Tiles</a> <a href="#">Square 47"w x 47"h - Set of 2 Tiles</a> <a href="#">Rectangle 47"w x 23.5"h - Set of 4 Tiles</a> <a href="#">Rectangle 23.5"w x 47"h - Set of 4 Tiles</a> <a href="#">Rectangle 70.5"w x 35.25"h - 1 Tile</a>	<a href="#">P1_ EchoScape™ 3/8" (9mm)</a> <a href="#">PR_ EchoScape™ Woodgrain</a>	<a href="#">W.R_ Adhesive Removable Mount (Qtys vary with size)</a>

**ECHODECO® WOODGRAIN TILES**  
**MATERIAL THICKNESS 3/8" (9MM)**

Shape	Width (Woodgrain runs along Width)	Height	Set Qty	List Price Per Set (Solid Colors)	List Price Per Set (Woodgrain Patterns)	Adhesive Removable Mount (Qty per Set)	Adhesive Removable Mount List Price	Weight Per Set (lbs)	Acoustic Material Square Footage Per Set
Plank	23.5"	5.88"	8	\$310	\$345	W.R24	+\$75	3	8 sq. ft.
Plank	5.88"	23.5"	8	\$310	\$345	W.R24	+\$75	3	8 sq. ft.
Plank	23.5"	11.75"	8	\$455	\$525	W.R32	+\$100	6	16 sq. ft.
Plank	11.75"	23.5"	8	\$455	\$525	W.R32	+\$100	6	16 sq. ft.
Square	23.5"	23.5"	8	\$687	\$802	W.R48	+\$150	12	31 sq. ft.
Square	47"	47"	2	\$687	\$802	W.R32	+\$100	12	31 sq. ft.
Rectangle	47"	23.5"	4	\$687	\$802	W.R32	+\$100	12	31 sq. ft.
Rectangle	23.5"	47"	4	\$687	\$802	W.R32	+\$100	12	31 sq. ft.
Rectangle	70"	35.25"	1	\$687	\$802	W.R16	+\$50	7	18 sq. ft.

**MOUNTING OPTION**



**COMMAND™ STRIP WALL ADHESIVE**

COMMAND™ STRIP WALL ADHESIVE CAN BE USED ON THE FOLLOWING SURFACES: PAINTED, STAINED OR VARNISHED WOOD, GLASS, TILE, PAINTED CINDER BLOCK, PLASTER, METAL, AND PAINTED WALLBOARD.

**PRESS LOCK ADHESIVE STRIP**

PRESS LOCK ADHESIVE ATTACHES TO PRODUCT WITH ADHESIVE AND TWO SCREWS (SCREW INSTALLATION REQUIRED)

**ADHESIVE REMOVABLE MOUNT (W.R)**



**23.5"W X 5.88"H PLANKS & 5.88"W X 23.5"H PLANKS**  
SHOWN IN BIRCH (PR182) & WALNUT (PR183)

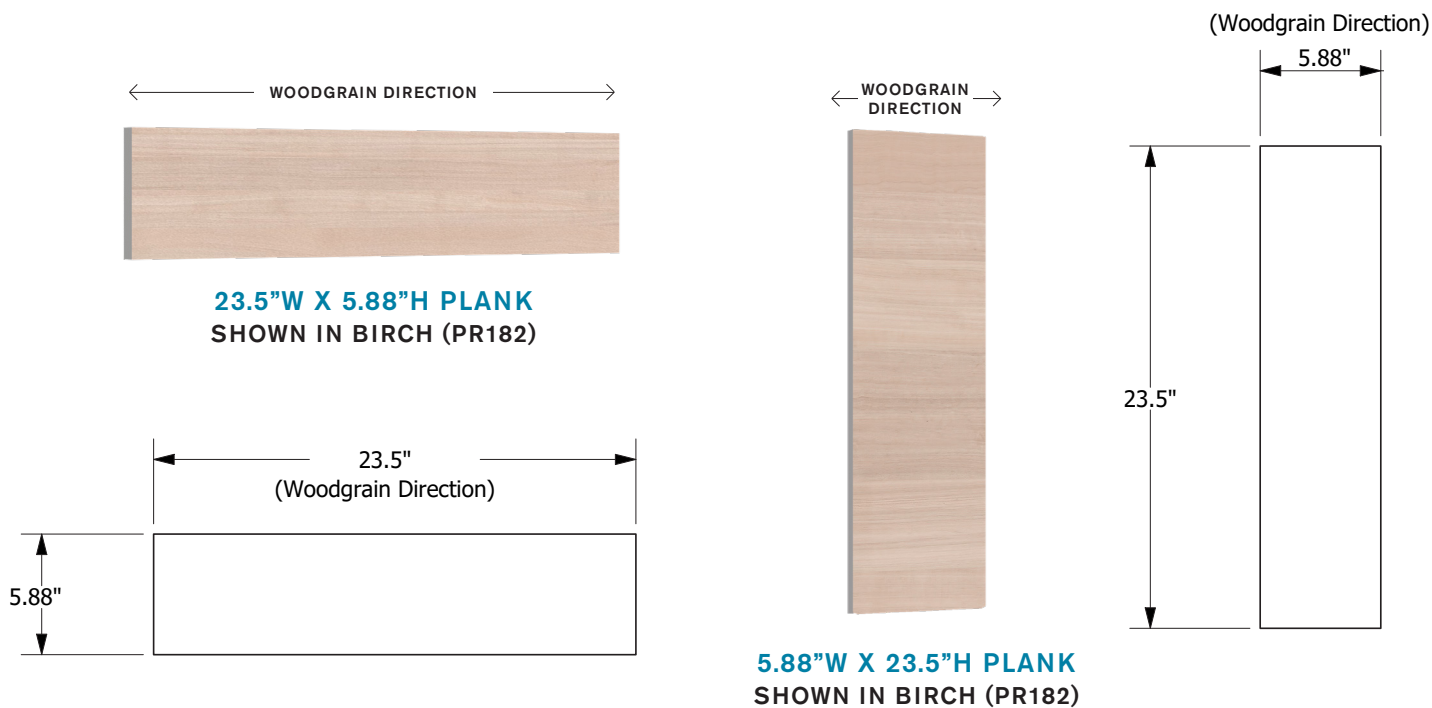



**23.5"W X 11.75"H PLANKS & 11.75"W X 23.5"H PLANKS**  
SHOWN IN BIRCH (PR182) & MAHOGANY (PR184)

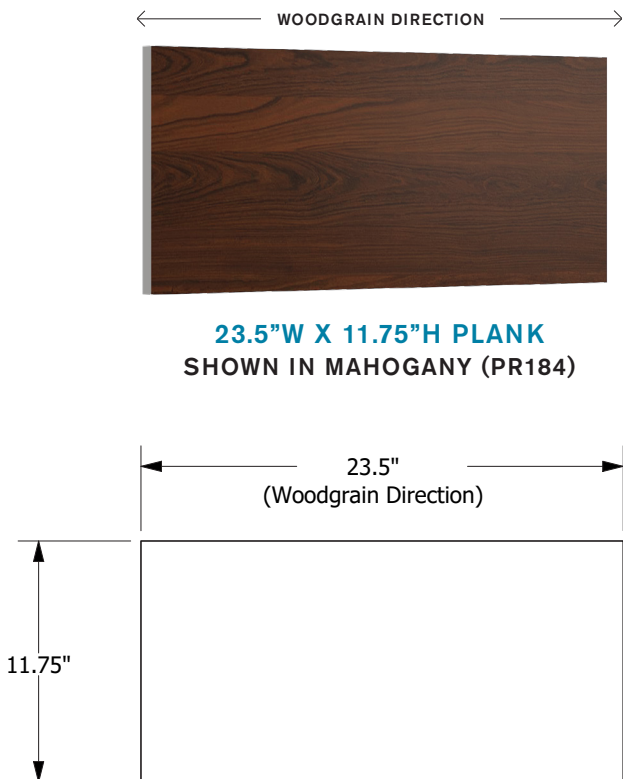



**23.5"W X 23.5"H SQUARES**

SHOWN IN BIRCH (PR182), MAHOGANY (PR184) & GRAPHITE GREY (PR181)

← WOODGRAIN DIRECTION →



**23.5"W X 23.5"H SQUARE**

SHOWN IN GRAPHITE GREY (PR181)

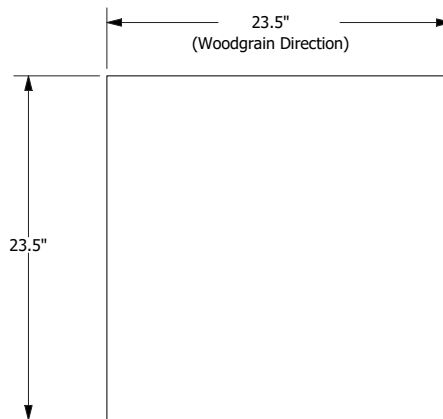



**47"W X 47"H SQUARES**  
SHOWN IN WALNUT (PR183) & MAHOGANY (PR184)

← WOODGRAIN DIRECTION →

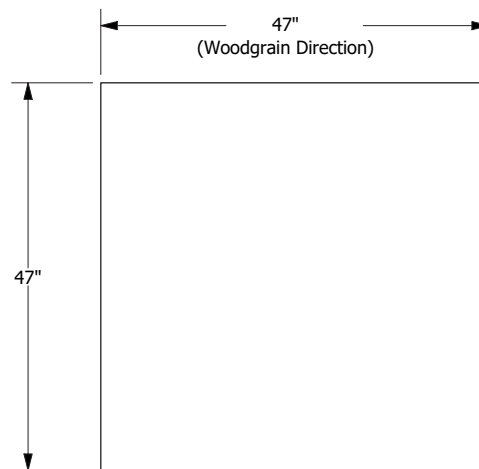

**47"W X 47"H SQUARE**  
SHOWN IN WALNUT (PR183)



**47"W X 23.5"H RECTANGLES & 23.5"W X 47"H RECTANGLES**  
SHOWN IN SNOW (P114) & CLASSIC GREY (PR180)

← WOODGRAIN DIRECTION →



**47"W X 23.5"H RECTANGLE**  
SHOWN IN CLASSIC GREY (PR180)

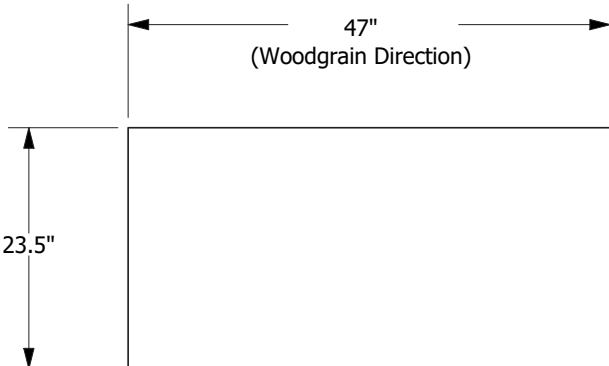

← WOODGRAIN DIRECTION →



**23.5"W X 47"H RECTANGLE**  
SHOWN IN CLASSIC GREY (PR180)

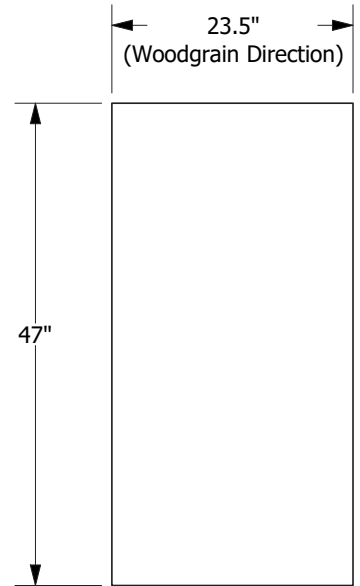



**70.5"W X 35.25"H RECTANGLES**  
SHOWN IN CLASSIC GREY (PR180) & GRAPHITE GREY (PR181)

← WOODGRAIN DIRECTION →

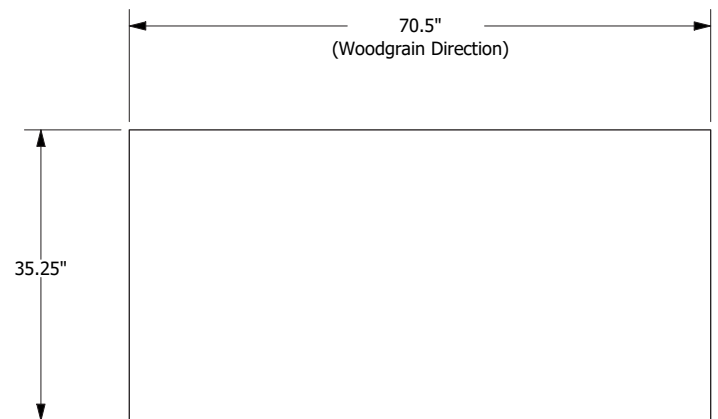

**70.5"W X 35.25"H RECTANGLE**  
SHOWN IN GRAPHITE GREY (PR181)



ECHOSCAPE™ 3/8" (9MM)

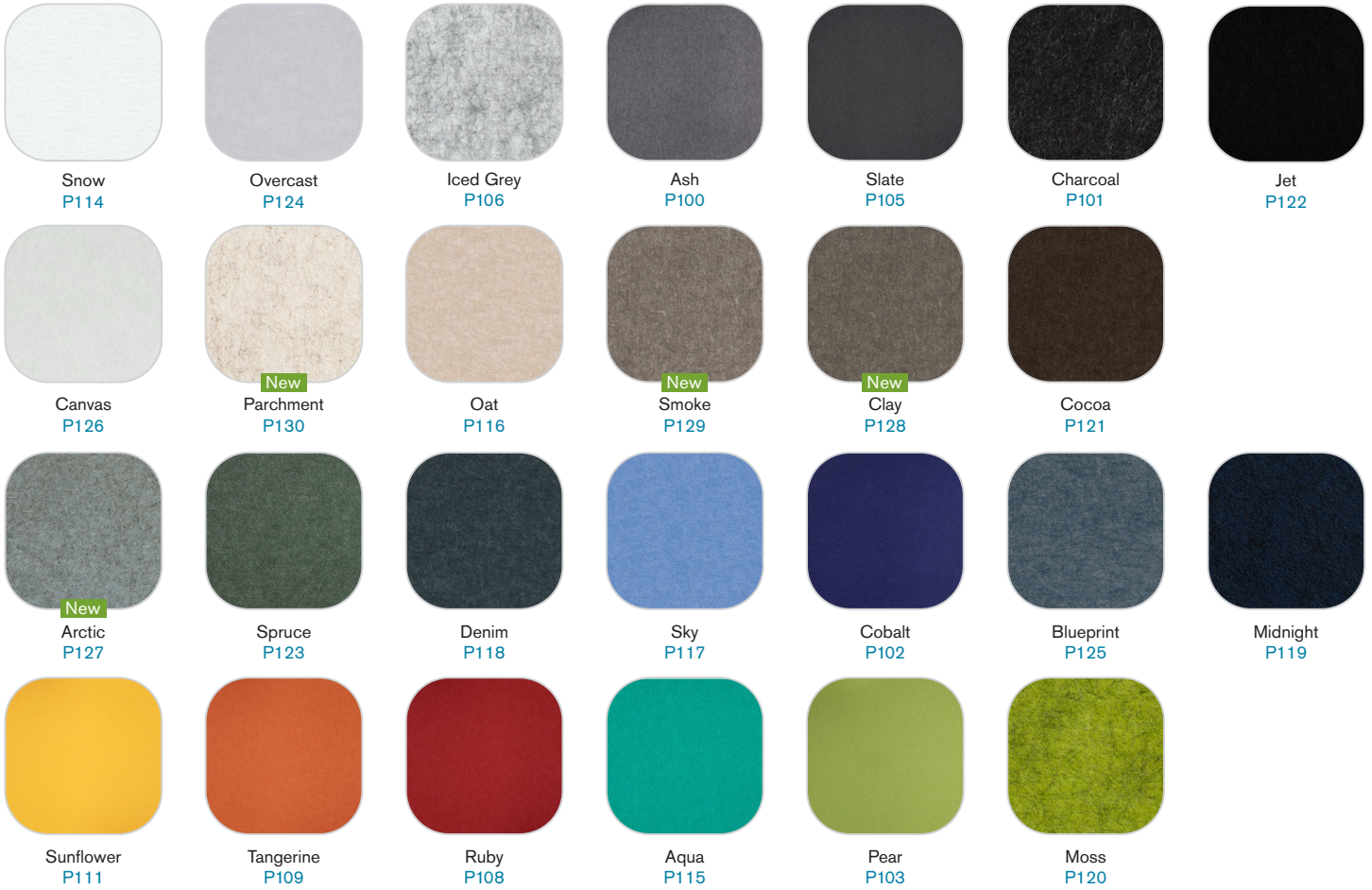

ECHOSCAPE® WOODGRAIN PATTERNS 3/8" (9MM)

Woodgrain pattern runs horizontal

